



**KRULL** GmbH  
 Gabelstapler · Lagertechnik · Kompressoren · Drucklufttechnik  
**Gabelstapler · Kompressoren**  
 Rüschehof 25 · 33397 Rietberg · Tel: 05244/939394 · www.krull-gmbh.de

 Gabelstapler Lagertechnik  Kompressoren Drucklufttechnik  
 TECHNOLOGIE DIE ÜBERZEUGT



**HANGCHA GROUP CO., LTD.**

Factory site: 666 Xiangfu Road, Hangzhou, Zhejiang, China (311305)

Tel: +86-571-88926735 88926755  
Fax: +86-571-88926789 88132890

sales@hcforklift.com www.hcforklift.com

HANGCHA GROUP CO., LTD. reserves the right to make any changes without notice concerning colors, equipment, or specifications detailed in this brochure, or to discontinue individual models. The colors of trucks, delivered may differ slightly from those in brochures.



Follow us on Facebook



Follow us on YouTube



Follow us on WeChat



Download "Hangcha Forklift" App



ISO45001:2018



ISO14001:2015



ISO9001:2015

# EZGO

## MINI PALLET TRUCK

With capacity of 2,000kg

2026 VERSION 16 / COPYRIGHT 2026 / 04

# CUTTING-EDGE INTELLIGENT DESIGN DRIVES AN EFFICIENT FUTURE

## Minimalist Aesthetics, Touching Myriad

EZGO is a material-handling AMR, whose overall design centers on a sense of futurism and technological vibe, presenting an entirely new visual expression. Its frontal design draws inspiration from the "Wild Ox": through clean and smooth lines, it outlines a compact yet powerful silhouette, integrating industrial aesthetics with modern texture.

The name "EZ" is a homophone of "easy", signifying easy implementation and simple operation; "GO" represents rapid launch. Together, the name conveys that in the AI-driven context of Industry 4.0, our product can deliver value and an optimal experience to customers with its image of convenience and intelligence.



Quick to launch

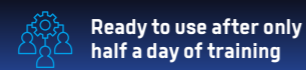

Ready to use after only half a day of training



No on-site modification required



Low cost



## Product Advantages

### Following the "Automation Ladder Theory"



Providing a "transitional solution" for customers who are not yet ready for fully autonomous AGVs: Small and medium-sized enterprises can achieve an automation start from 0 to 1 through EzGo.

### Dynamic Path Planning, Intelligent Obstacle Avoidance



Multi-sensor Fusion: Effectively identifies obstacles and navigates around them, minimizing changes to existing usage habits while ensuring efficient operation.

### Workshop Automatic Communication, Intelligent Traffic



Within 5-10 Meters: Vehicles mutually exchange planned path information, enabling orderly traffic merging.

### Rapid Battery Swapping



Rapid Energy Replenishment: Lithium Iron Phosphate Battery, Replaceable quickly with one person using one hand.

## DELIVERING UNPARALLELED ROBUSTNESS

With high power drive motor, provides fast travel speed and good gradeability.

Travel speed ▼

1.5m/s

Lift speed ▼

0.25m/s

Max. gradeability ▼

5%

# THE FUTURE LOOKS FAMILIAR

EZGO deeply integrates the concepts of ergonomics and technological aesthetics into its structural design, while balancing the unity of functionality and visual experience.

## Appearance

The overall vehicle design adopts streamlined curved surfaces and rounded chamfers, which effectively softens the sense of sharpness at the edges, enhances visual softness, and allows it to present a more natural, approachable and modern external form in diverse application scenarios.



### Humanized Detail Consideration

A built-in Cup Holder allows operators to place cups or documents at any time.



### Scientifically Laid-out Control Components

The control buttons and joysticks are reasonably arranged, enhancing operational precision and efficiency.

### Modern LED Turn Signal Light Strip

Integrated with the "Wild Ox"-styled main unit, it boasts a sharp exterior.

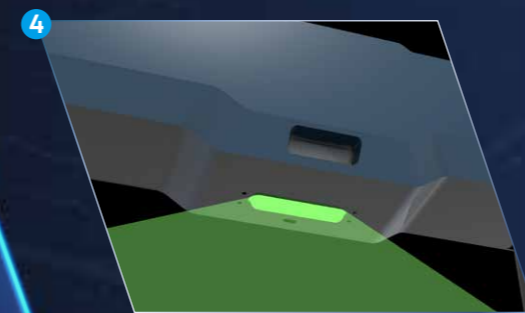

### Optimized Design of Status Indicator Lights

The indicator lights face downward, ensuring the maximum visible range and thus enhancing operational safety and operational intuitiveness.



### Touchscreen

All operations can be completed on the touch screen.



### "Wild Ox"-Inspired Dynamic Exterior

Its power-infused styling, combined with a robust body, showcases strong load-bearing capacity and stable performance.



### Modular Maintenance Design

Core components enable rapid disassembly and assembly, thus cutting maintenance costs and boosting O&M efficiency.



# THE 5 STRENGTHS

## ONE POWERFUL LIFT

### Product Configuration

Tiller handler and control components adopt an ergonomic scientific layout, which greatly optimizes operational convenience and field of vision, while significantly enhancing operators' comfort level and operational efficiency. The overall line design is simple and smooth, with natural and seamless structural connections, fully demonstrating the product's high-end quality and technological aesthetics.

**1 RK3588**  
Computing Platform Powerful Computing Power, Handles Tasks with Ease



**2 LASER NAVIGATION**  
No Feature Implementation Required, Standard 3D Radar



**3 Steering Servo, Locomotion Control Sufficient Power, Precise Positioning**



**4 Visual Obstacle Avoidance AI Following**



**5 Laser Detection, Safe and Reliable**



Autonomous

Precise

Efficient

Flexible

Safe

Reliable



## REMOTE CONTROL AT YOUR FINGERTIPS.

Human-vehicle cooperation: complete manual positioning in 3 minutes, take effect in real-time.

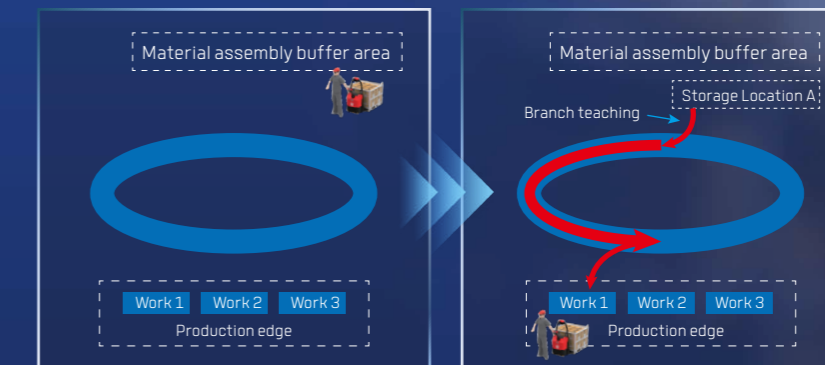

**Business Scenario:** Workers need to pick up goods from the buffer area and replenish them to the line-side workstations.

### APP Introduction

Supports remote updates for in-vehicle and APP software



#### Simple operation

Easier implementation, simple positioning, fast task execution



#### Modifying convenient

Stations & routes visualized, easy deletion of abnormal data



#### Multiple scenarios

Diversified task types adapt to multiple production scenarios

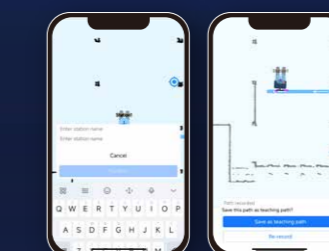

Manual positioning completed synchronously

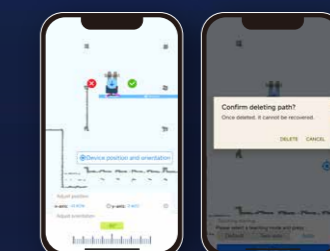

Site coordinate adjustment and deletion

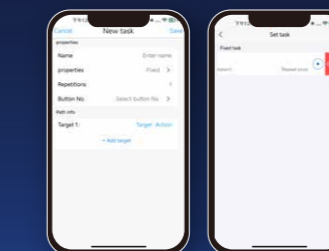

Configure tasks and launch with one click

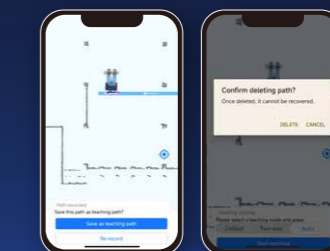

Routes support CRUD operations

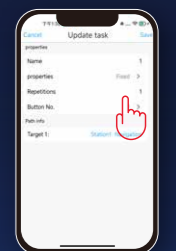

Freely configure task types and operation attributes